

- **Material grades: 316L urea grade / 25.22.2-UNS S31050**
- **Hydro test according to customer's requirements (generally 250 Kg/cm²)**
- **Realisation according to customer's drawings and specifications**

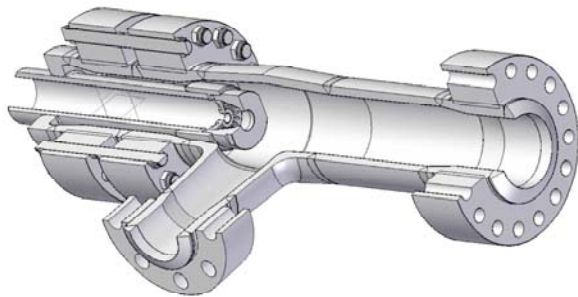

Control processes are executed as follows:

- Visual and dimensional control at receipt of raw materials;
- PMI test to check conformity;
- Liquid penetrant or magnetic test according to type of material;
- Ultrasound test;
- Radiographic test;
- Hydraulic test;
- Color code execution;
- Final visual dimensional control, marking check and heat traceability;
- Third party stamping and identification.

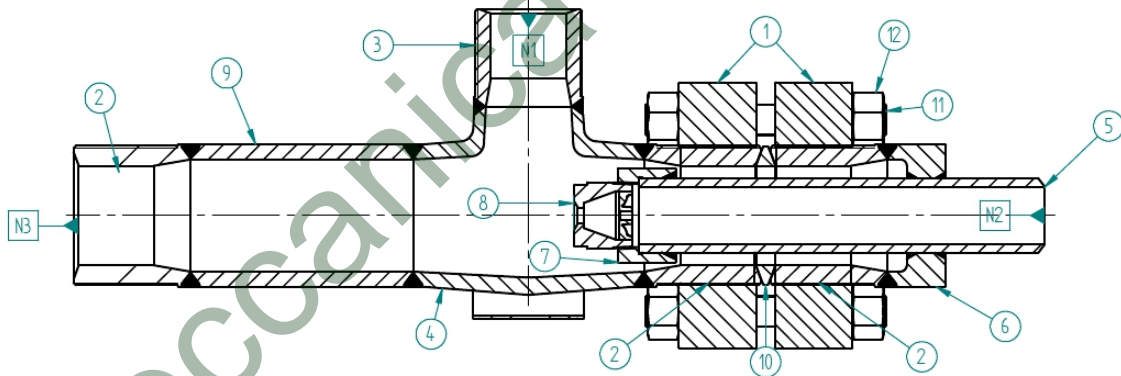
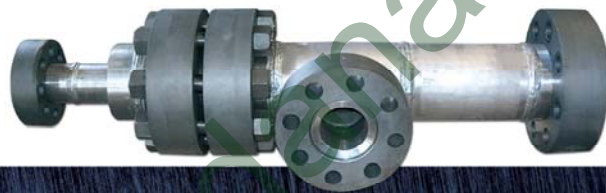

QTY	ITEM	DESCRIPTION	ITEM	DESCRIPTION	QTY
	1	SCREWED FLANGE Std. TB HPU 5002 ASTM A105	10	LENS GASKET Type "A" STD TB HPU 5002 ASTM A182 F316L/M U.G.	
	2	SCREWED NOZZLE Std. TB HPU 5002 ASTM A182 F316L/M U.G.	11	STUD BOLTS IN A193B7	
	3	SCREWED NOZZLE Std. TB HPU 5002 ASTM A182 F316L/M U.G.	12	NUTS IN A1942H	
	4	TEE BW STD TB HPU 5002 ASTM A182 F316L/M U.G.	16		
	5	PIPE ASTM A182 F316L/M U.G.	17		
	6	SPECIAL CAP ASTM A182 F316L/M U.G.	18		
	7	SPECIAL COUPLING NPT/Female SW ASTM A182 F316L/M U.G.	14		
	8	SPRAYER NPT/male 30° Full come jet ASTM A182 F316L/M U.G.	15		
	9	PIPE ASTM A182 F316L/M U.G.			

DESIGN DATA

NORMAL PRESSURE:
NORMAL TEMPERATURE :
DESIGN PRESSURE:
DESIGN TEMPERATURE:
TEST PRESS.:
FLUID TYPE:
SPRAYER FLOW-RATE:
SPRAYER DFF. PRESS.:

REV	DESCRIPTION	RED	VER	EOC
0				



CLIENTE/CUSTOMER

OGGETTO/OBJECT: CARBAMATE MIXER

NOZZLE	SIZE	CONNECTION TYPE	SERVICE	NET WEIGHT Kg.
N1		SPECIAL LENS	VAPOUR INLET	
N2		BUTT WELD	LIQUID INLET	
N3		SPECIAL LENS	VAPOUR LIQUID OUTLET	

SCALA	DIS. DWG.	LA MECCANICA PADANA	N°
JOB			